



SPARE PART LIST

Spare Part ItemCode	Item name.	PictureId
6260.00151.11	FLEXIBLE STEEL CONDUIT Ø40mm FOR WIRING HARNESS	101
6259.00001.08	FLEXIBLE STEEL CONDUIT Ø40mm	102
6259.00003.05	CABLE GLAND PG 13,5 GRAY	103
6248.00010.01	Electric Terminal Rail Nu 6(Grounding)	104
6248.00011.00	KLEMENS DURDURUCU KD-3 KLEMSAN 495040 BEJ	105
6248.00011.11	KLEMENS AVK 16 BEJ	106
6248.00011.15	KLEMENS AVK 10 MAVI	107
6230.00014.06	CONTACTOR	108
6248.00022.00	RAIL FOR TERMINAL ST	109
6221.00001.02	Clamp 12X20 MM.	110
6262.00021.18	Boiler Hose(inlet)	111
6234.00001.26	SAFETY THERMOSTAT 365 C	112
6234.00001.05	THERMOSTAT 50-300 C MONOPHASE	113
6260.00015.45	THERMOPLASTIC KNOB MAIN BODY WITH 6 mm INSERT	120.1
6260.00015.49	THERMOPLASTIC KNOB SCALE WITH "O" MARKED FOR "OK"	120.2
2KLP.460.626200038.02	NUT BRASS R1/2"x5 mm	121
2KLP.460.626700042.04	ADAPTER BRASS 1/2" TO 5/8" +UNION+FERRULE	122
2KLP.460.626000151.24	BUSHING BRASS FOR TILTING MECHANISM OF BRATT PANS ON MAIN BODY	24
6260.00002.10	ADJUSTABLE FEET	30
6232.00007.02	LIMIT SWITCH FOR PAN OF BRATT PANS	47
2867.N30.GR001.06	50-80-100-130 LT DEVR L R TAVA KAPAK MEKAN ZMASI GRUBU	49
6260.00015.45	THERMOPLASTIC KNOB MAIN BODY WITH 6 mm INSERT	60
6260.00015.32	THERMOPLASTIC KNOB SCALE 50-300 C	61
6234.00001.11	ENERGY REGULATOR	62
6251.00004.31	SIGNAL LAMP BLACK BODY RED LENS NEON 100K-220V	63
6262.00008.00	3/4 PLASTIK VENTILLE	64
6251.00004.30	SIGNAL LAMP BLACK BODY GREEN LENS NEON 100K-220V	65
6222.00015.10	SPOUT FILLING FRESH WATER FOR TILTING BRATT PANS	71
2KLP.460.622200008.130	HOSE PIPE FITTING BRASS 5/8" FOR FILLING WATER SPOUT	72
2179.09028.01	LABEL FOR FRONT PANEL "ÖZT RYAK LER"	73
6232.00012.08	Moeller Button Top DR-G	75
6259.00003.10	CABLE GLAND PG 21	78
6260.00098.00	HANDWHEEL (200mm)	80
6260.00098.04	FOLDABLE HANDLE FOR HANDWHEEL-M10	81
2KLP.460.626000151.03	DEVIRLIR TAVA MIL SOMUNU	84
2KLP.460.626000151.02	DEVIRLIR TAVA KALDIRMA MILI	85
6246.00002.00	HEATING ELEMENT 1500 W 230 V 750&80-100-130-205 BRAT PANS	93
6260.00058.96	FLUE COVER CAST IRON WITH CERAMIC ENAMEL COATED FOR ALL 700&900	95



DİKKAT: BU DOKÜMANIN COĞALTILMASI İNTERNET ORTAMINDA DOLAŞTIRILMASI VE BU ÇİZİMLER DOĞRULTUSUNDA ÜRETİMİN YAPILMASI ÖZTİRYAKLER FİRMASININ ONAYI İLE OLABİLİR. TÜM HAKLARIMIZ SAKLIDIR.

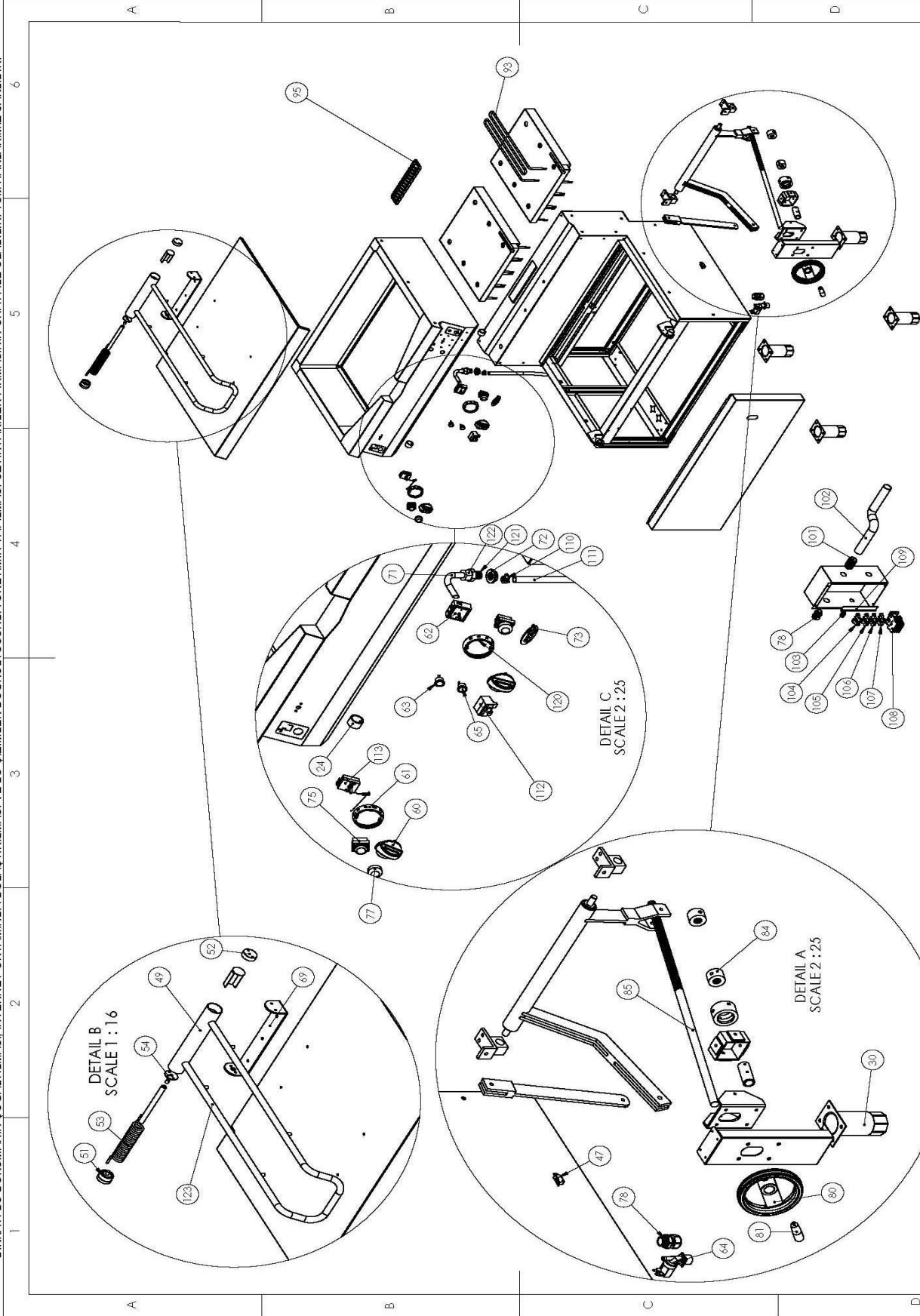

RİSD	BİM	İMEÇA	TARİHİ	MATERYAL	TOLERANS	öztiyakiler	
ÇİZEN	E.BAŞTUĞ		25.04.2011		DIN 7168	PARÇA ADI	130 LT ELEKTRİKLİ DEVRİLİR TAVA (YENİ MODEL)
KONTROL	M.HACI		25.04.2011		ORTA		
ONAY	M.HACI		25.04.2011				
AĞIRLIK(KG)		15795,38	KALINLIK	REVİZYON	ÖLÇEK	1:50	T. RESİM NO
RESİM ÜZERİNDEN ÖLÇÜ ALMAYINIZ!		TÜM ÖLÇÜLER MM ÇİNSİNDİR					
ARGE		KONTROLLÜ KOPYA					
V13.01							

WARNING: IT IS APPROPRIATE TO MULTIPLY, USE, DISPLAY AT COMPUTER/INTERNET AND PRODUCE THE PRODUCT WITH ITS DRAWINGS WITH THE APPROVAL OF ÖZTİRYAKLER COMPANY. ALL RIGHTS RESERVED.